

GATE VALVE PN16 (F4) series 117



APPLICATION

Flanged gate valve for drinking water and neutral liquids up to 70°C

DESIGN FEATURES

Non rising stainless steel stem	Guided wedge to ensure correct sealing
Full bore	100% watertight
Low closing torque	No zones of retention
Clockwise closing	Replaceable wedge nut

TECHNICAL CHARACTERISTICS

Design in accordance to EN1074 and EN1171
 Face to face dimensions according to EN 558-1 and DIN3202 (F4)
 Flange end connections according to EN1092-2: PN10&PN16
 Maximum working pressure: PN16 / 16 bar
 Working temperature: 0°C - +70°C
 Fully vulcanized wedge in EPDM according to EN681
 Stainless steel bolts
 Color RAL5015
 Powder epoxy coating at least 250 µm thickness

OPERATING



DN	Flange drilling	L	H	D	D1	D2	b	n-Ød	SQ	KG	BLUCAST ref. no.
50	PN10/16	150	198	165	125	99	16	4x19	14	10.6	117050
65	PN10/16	170	252	185	145	118	16	4x19	14	11	117065
80	PN10/16	180	255	200	160	132	16	8x19	17	12.6	117080
100	PN10/16	190	301	220	180	156	16	8x19	17	18	117100
125	PN10/16	200	336	250	210	184	16	8x19	19	26.9	117125
150	PN10/16	210	364	285	240	211	16	8x23	19	30.2	117150
200	PN10	230	473	340	295	266	17	8x23	24	53	117200
250	PN10	250	550	400	350	319	19	12x23	27	73.5	117250
300	PN10	270	642	455	400	370	20.5	12x23	27	107.4	117300
350	PN10	290	777	505	460	429	20.5	16x23	27	155	117350
400	PN10	310	852	565	515	480	20.5	16x28	27	200.8	117400
450	PN10	330	945	615	565	530	21.5	20x28	27	295	117450
500	PN10	350	1030	670	620	582	22.5	20x28	32	340	117500
600	PN10	390	1165	780	725	682	25	20x32	32	535	117600

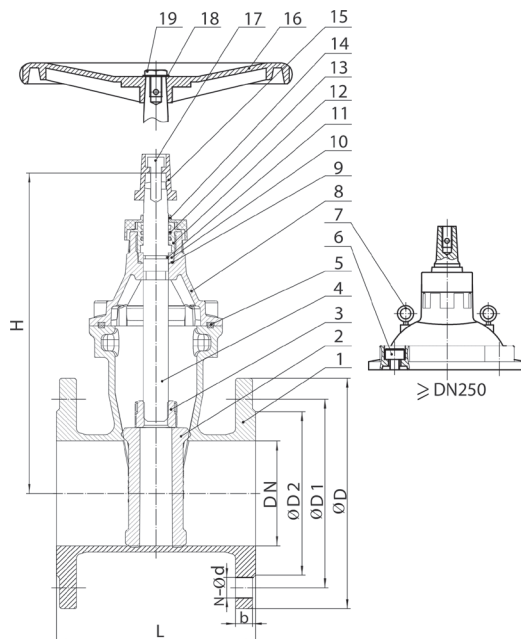

No.	Item	Material
1	Body	EN-GJS-500-7
2	Wedge	EN-GJS-500-7, EPDM
3	Wedge nut	Brass
4	Stem	AISI 420
5	Sealing gasket	EPDM
6	Bolts	AISI 304
7	Lifting bolt	AISI 304
8	Bonnet	EN-GJS-500-7
9	Sealing ring	EPDM
10	Sealing ring	EPDM
11	Sealing ring	EPDM
12	Stem nut	Brass
13	Sealing ring	EPDM
14	Dust seal	EPDM
15	Stem cap	EN-GJS-500-7
16	Handwheel	EN-GJS-500-7
17	Bolts	AISI 304
18	Washer	AISI 304
19	Bolts	AISI 304

All illustrations, technical data, dimensions (in mm) and weights (all weights specified in kg) are non-binding and are subject to change



VALVES

